

# MIRAMICHI POWER CENTRE

## MIRAMICHI, NB

**Address** 98-102 Douglastown Boulevard, Miramichi,  
New Brunswick

**Area** 58,000 sq. ft.

**Parking  
Spaces** 380

**Major  
Retailers** Staples, Mark's Work Wearhouse

**Property  
Summary** This property is strategically located near the  
new Miramichi Wal-Mart and is in close  
proximity to: Canadian Tire, Sobeys and the  
Northumberland Mall (the area's regional mall).



**Address:**  
527 Queen Street, Suite 200  
Fredericton, NB  
E3B 1B8



**Contact:**  
Myles Martin  
506-451-1826  
myles.martin@plaza.ca



# MIRAMICHI POWER CENTRE

Miramichi, N.B.

## PHASE II

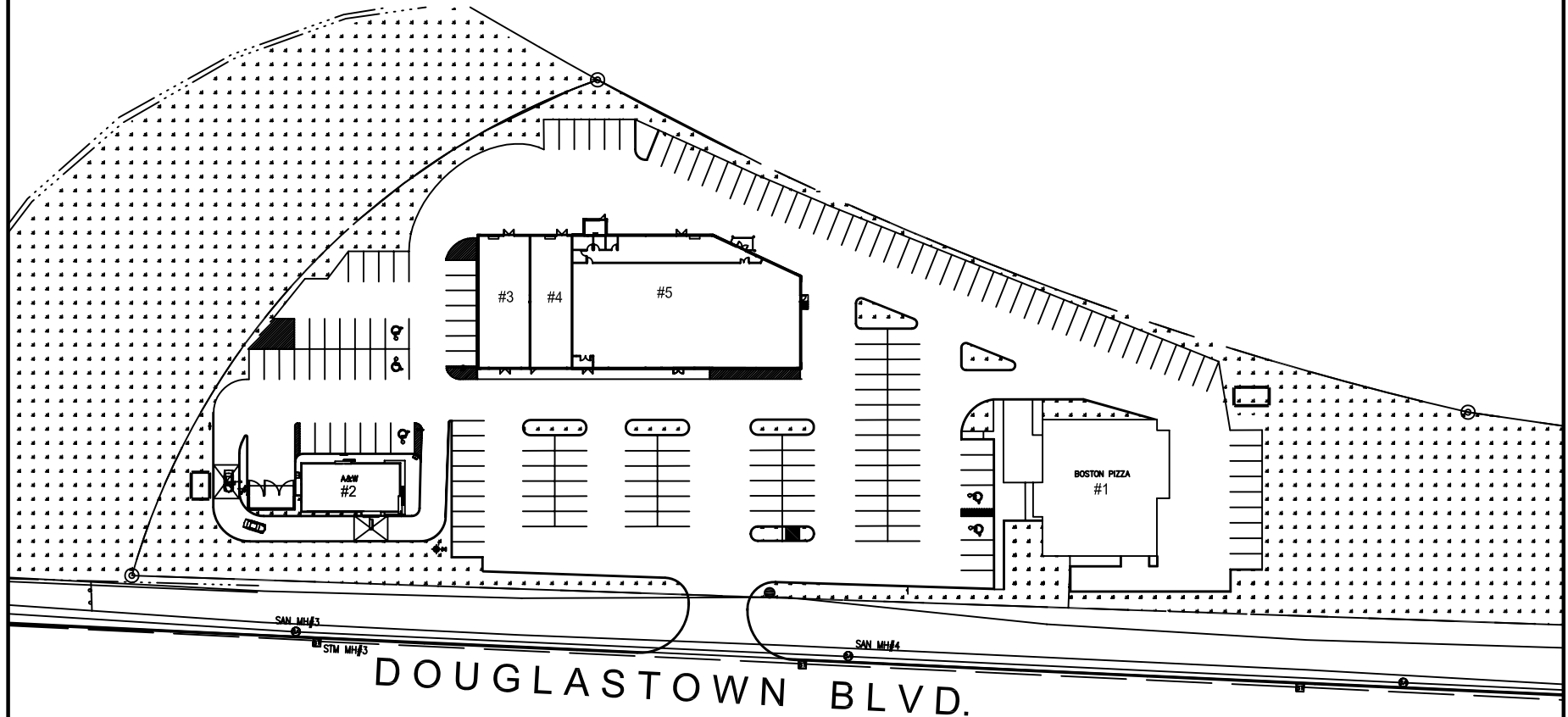

<u>Tenant</u>	<u>sq.ft.</u>
1. Boston Pizza	5 600
2. A&W	2 400
3. Payless Shoes	2 439
4. Wello Fargo	2 000
5. Dollarama	10,077

### THE PLAZA GROUP

527 Queen Street, Suite 200  
Fredericton, N.B.  
E3B 1B8  
Tel.:506-451-1826  
Fax.:506-451-1802

90 Morgan Rd, Suite 200  
Baie D'Urfe, Quebec  
H9X 3A8  
Tel.:514-457-7007  
Fax.:514-457-0220  
[www.plaza.ca](http://www.plaza.ca)

REVISED: January 22, 2009 rev."I"

DATE : October 06, 2004