

# BEDFORD COMMONS PHASE II BEDFORD, NS.

**Address** 181 Damascus Road, Bedford, Nova Scotia

**Area** 105,157 sq. ft.

**Parking  
Spaces** 492

**Major  
Retailers** Winner's, Staples, Sportchek

**Property  
Summary** This property is situated just off the highway in a growing retail area including Wal-Mart, Canadian Tire and Bedford Commons Phase I.



**Address:**  
82 Tacoma Drive, Suite 207  
Dartmouth, NS  
B2W 3E5



**Contact:**  
Verna Bulley  
902-468-8688  
[verna.bulley@plaza.ca](mailto:verna.bulley@plaza.ca)

# BEDFORD COMMONS PLAZA - Ph. II

BEDFORD, N.S.

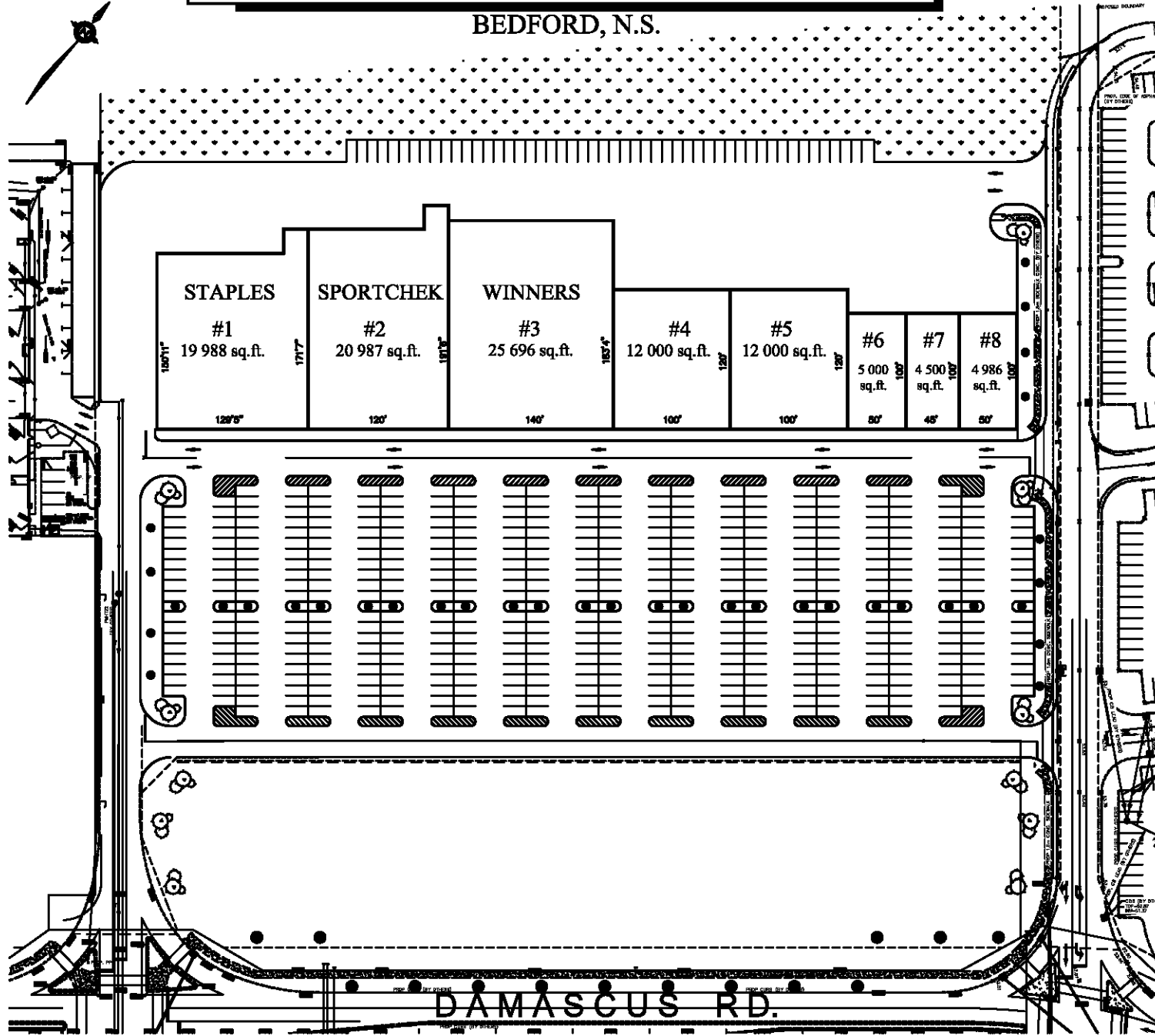

## BEDFORD COMMONS PLAZA - Ph. II

Bedford, N.S.

Tenant	sq.ft.
1. Staples	19,988
2. Sportchek	20,987
3. Winners	25,696
4. Available	12,000
5. Available	12,000
6. Available	5,000
7. Available	4,500
8. Penningtons	4,986

REVISED: January 12, 2012 rev."D"

DATE: January 19, 2011

### THE PLAZA GROUP

82 Tacoma Drive, Unit 207  
Dartmouth, Nova Scotia  
B2W-3E5

Tel.: 902-468-8688  
Fax.: 902-468-9446

90 Rue Morgan, Suite 200  
Baie D'Urfe, Quebec  
H9X-3A8

Tel.: 514-457-7007  
Fax.: 514-457-0220

[www.plaza.ca](http://www.plaza.ca)