

GRANITE DRIVE PLAZA NEW MINAS, NS

Address 9293 Commercial Street, New Minas, NS

Area 150,000 sq. ft.

Major Retailers Winners, Future Shop, Lawtons, Home Depot (Retailer owned)



Address:
527 Queen Street, Suite 200
Fredericton, NB
E3B 1B8



Contact:
Myles Martin
506-451-1826
myles.martin@plaza.ca

GRANITE DRIVE PLAZA

NEW MINAS, N.S.

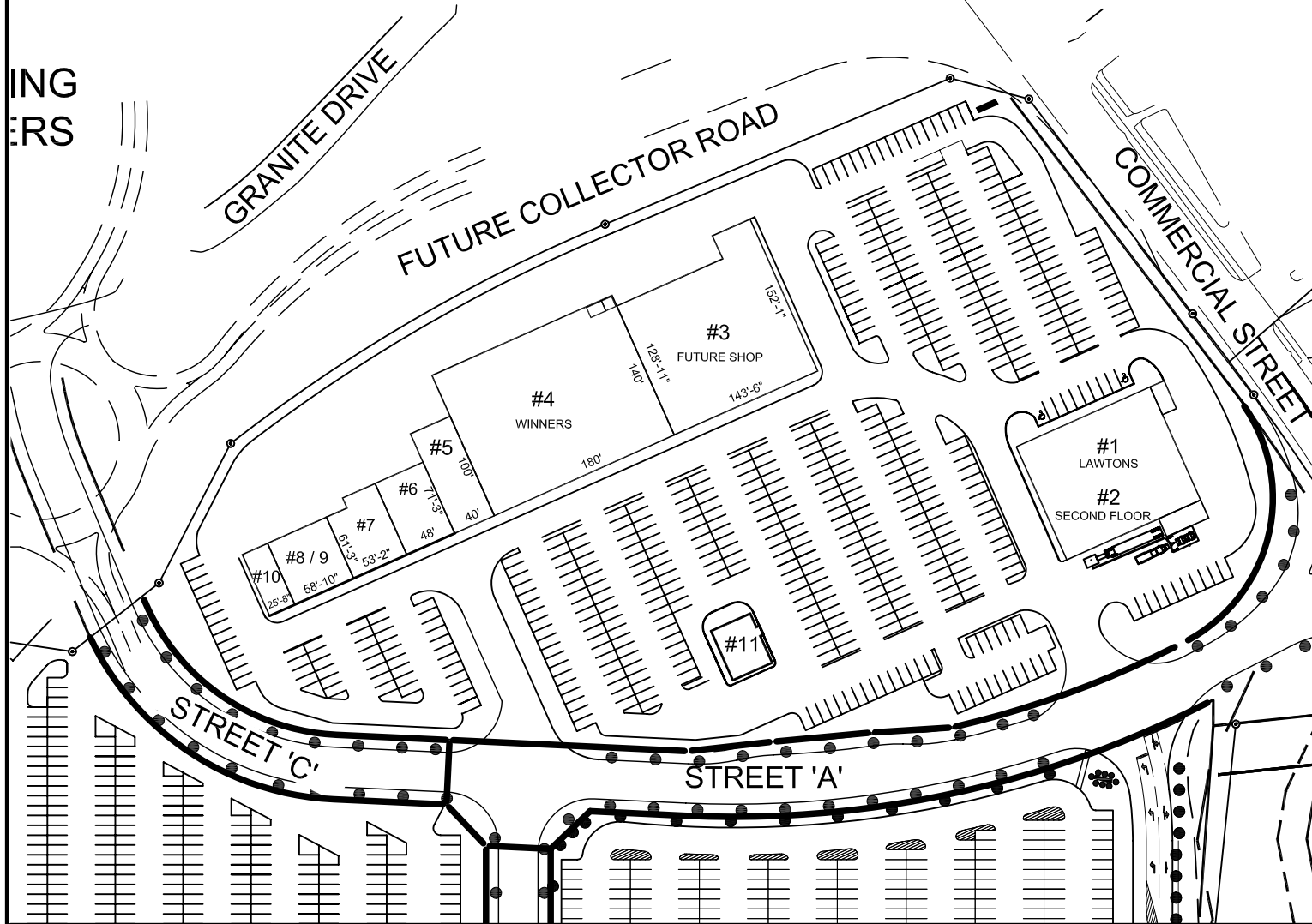

GRANITE DRIVE PLAZA NEW MINAS, N.S.

Tenant	sq.ft.
1. Lawtons	16,281
2. Lawtons Medical	6,693
3. Future Shop	20,000
4. Winners	25,000
5. Reitman's	4,000
6. Tan Jay Alia	3,500
7. Wicker Emporium	3,500
8/9. Pet Valu	3,580
10. Sally Beauty	1,513
11. Payless Shoes	2,500

REVISED: June 10, 2011 rev."K"

DATE: Oct. 23, 2008

THE PLAZA GROUP

82 Tacoma Drive, Unit 207
Dartmouth, Nova Scotia
B2W-3E5

Tel.: 902-468-8688
Fax.: 902-468-9446

90 Rue Morgan, Suite 200
Baie D'Urfe, Quebec
H9X-3A8

Tel.: 514-457-7007
Fax.: 514-457-0220

www.plaza.ca