

# SPRING PARK PLAZA CHARLOTTETOWN, PEI

**Address** 339 University Avenue, Charlottetown, PEI

**Area** 54,202 sq. ft.

**Parking Spaces** 200

**Major Retailers** Co-Op Grocery (retailer owned), Fabricville, Value Village

**Property Summary** Spring Park Plaza is located in the heart of Charlottetown in close proximity to the “downtown business” district. This easily accessible centre offers a number of “value oriented” stores.



**Address:**  
82 Tacoma Drive, Suite 207  
Dartmouth, NS  
B2W 3E5



**Contact:**  
Verna Bulley  
902-468-8688  
verna.bulley@plaza.ca

# SPRING PARK PLAZA

CHARLOTTETOWN, P.E.I.

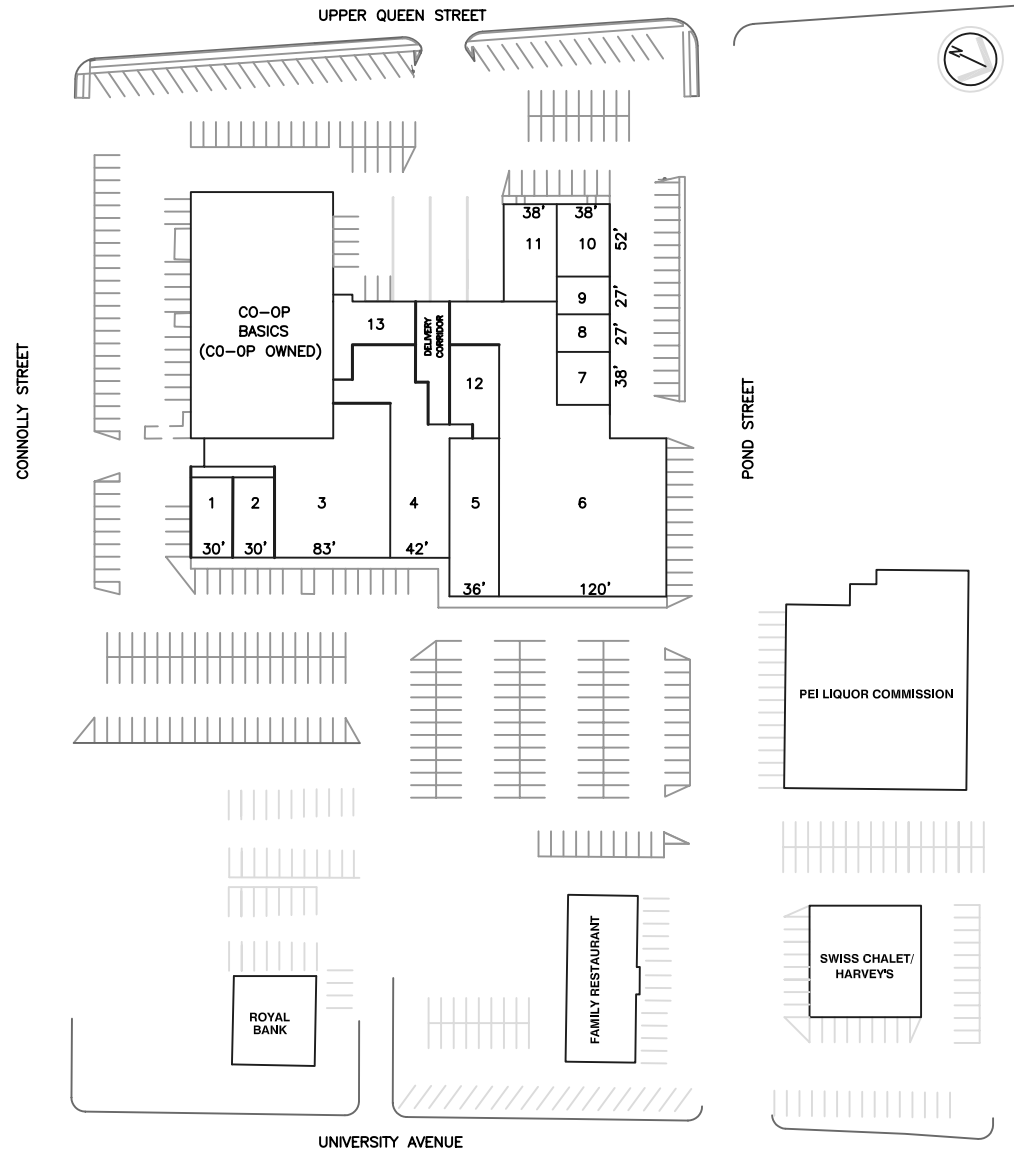

## SPRING PARK PLAZA

University Ave. & Pond Street  
Charlottetown, P.E.I.

<u>Tenant</u>	<u>sq.ft.</u>
1. Planet Beach Spa	1,710
2. Micro Play	1,700
3. Fabricville	9,141
4. Cash Converters	6,406
5. Easy Home	3,971
6. Value Village	19,106
7. Available	1,245
8. PC Assoc. of P.E.I.	1,000
9. Banks Financial	991
10. Beacon Signs	2,534
11. Napa	2,934
12. Available Storage	2,816
13. Available	2,383
CO-OP	20,000

REVISED: October 12, 2011 rev."I"

DATE : October 5, 1998

### THE PLAZA GROUP

82 Tacoma Drive, Unit 207  
Dartmouth, Nova Scotia  
B2W-3E5

Tel.:902-468-8688  
Fax.:902-468-9446

90 Rue Morgan, Suite 200  
Baie D'Urfe, Quebec  
H9X-3A8

Tel.:514-457-7007  
Fax.:514-457-0220

[www.plaza.ca](http://www.plaza.ca)